

FRH-A2

Heavy-Duty Automatic Fillet Rolling Machine



Key Points

- Rolling the underhead radius
- 2 Modes: Fully automatic loading or Semi-automatic loading
- Fully-automatic mode - Approximately 400 parts per hour
- Semi-automatic mode 200 - 1000 parts per hour depending on size
- Precise, programmable rolling parameters with 100% in-process checking
- Fast changeover
- Safe, clean working
- Easy maintenance
- Industry 4.0 compatible
- Specially-written user-friendly software in multiple languages

Application

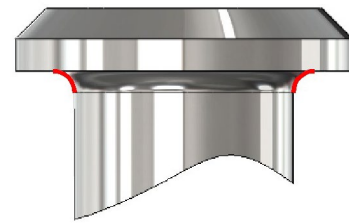
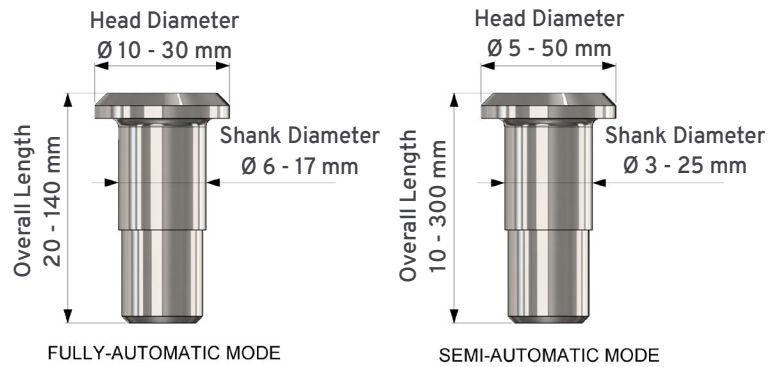

Features

- 24" / 600 mm \varnothing Vibratory Bowl Feeder
- Servo-controlled Loading Arm
- Load cell to measure actual rolling force during each cycle and to check that it is within programmed limits
- Programmable control of rolling force, rpm & time
- Drive unit with inverter controlled spindle motor
- Allen Bradley or Siemens PLC control system with touch-screen HMI
- Integrated coolant tank, filter and pump

Semi-automatic Mode (Manual Loading):

- Manual loading cycle initiated by touch sensitive two-hand safety buttons
- Safety light curtain to protect operator during cycle

View product at e-tech.co.uk

or contact sales@e-tech.co.uk